

# 37183-HK

## TO-220 Heat Sinks

### Economy, narrow base, low profile channel style heat sink



**Economy, narrow base, low profile channel style heat sink** is perfect for use on printed circuit boards with 0.500 inch centering. When mounted horizontally, the total height of the heat sink is just 0.380.

#### ORDERING INFORMATION

Part Number	Finish
THM 6073	Black anodize
	Replaced by
507302B00000G	Black anodize

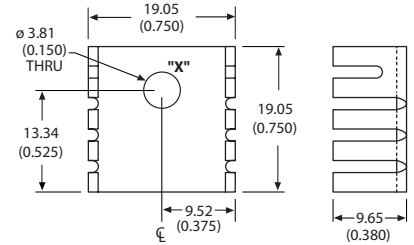
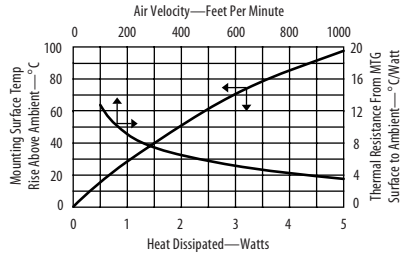

Material: 1.27 (0.050) Thick Aluminum  
Finish: See Table

#### POPULAR OPTIONS: 507302\_000 00G

Position	Code	Description	Location
A	09	Stud 4-40 x 0.350 LG	Hole X