

36518-OP

LED Product Specifications

Part Number:	36518-OP
Name:	Φ8 Straw Hat 0.75W White
VER:	Page 1 of 3

1. Dimensions

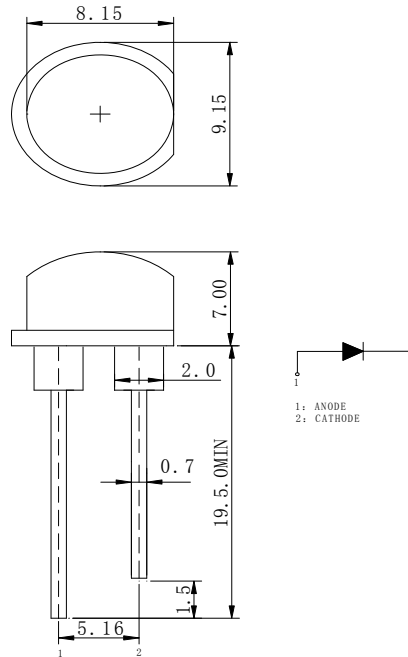

Description: (1) units: mm; All tolerances are $\pm .15$ mm.

2. Maximum use conditions (Ta= 25°C)

Item	Symbol	Value	Unit of Measure
Current Max DC	I _F	200	mA
Pulsed Current ^①	I _{FP}	250	mA
Reverse Voltage	V _R	5	V
Operating Temp.	T _{opr}	-40 ~ 85	°C
Storage Temp.	T _{stg}	-40 ~ 85	°C
Solder Temp ^{②③}	T _{sol}	260	°C

Notes: ①Pulse Width≤10msec, Duty Cycle≤1/10

②Space between Solder & Base≥3mm, Dwell Time: <5sec

③The equipment must be fully grounded.

3. Optical Parameters (Ta = 25°C)

Test	Symbol	Condition	Min	Typ.	Max.	Unit
Power	P _D	I _F 200mA		350		mW
Forward V	V _F	I _F =200mA	3.0	3.0	3.4	V
Reverse I	I _R	V _R =5V	0		1	μ A
Color	(X,Y)	I _F = 200mA	7000		9000K	*See Note
Flux	ϕ V	I _F = 200mA	55		65	Lumens
½ Angle	20½	I _F = 200mA		60		° Degrees

Note: * Please refer to the product color coordinates for details Page3 Shipping BIN Chart

LED Product Specifications

Part Number: 35836-OP

Name: Φ 8 Straw Hat 0.75W White

VER: Page 2 of 3

4. Characteristic curves (Ta = 25°C)

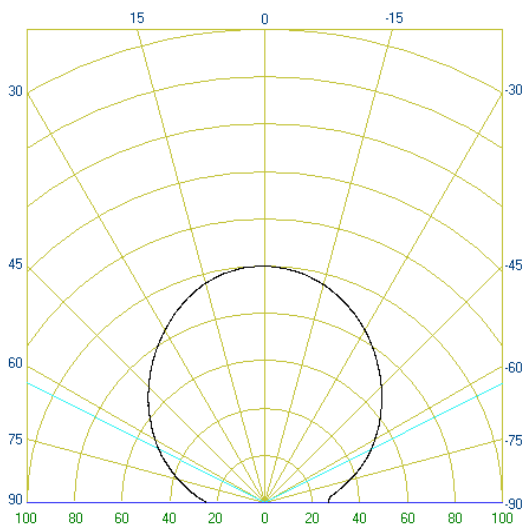
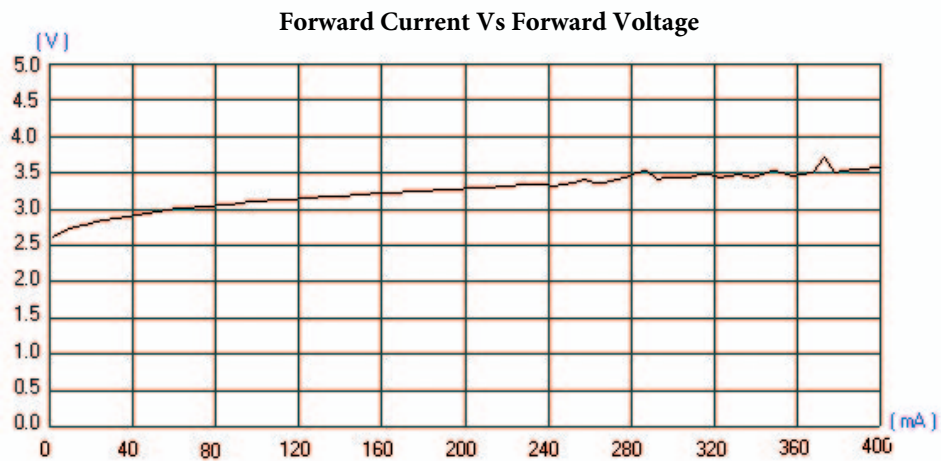
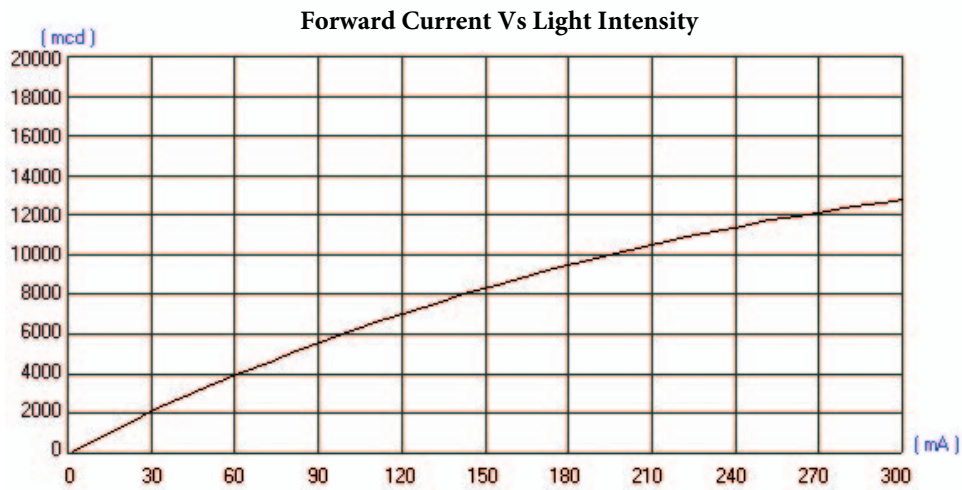

Light Intensity Angle Distribution

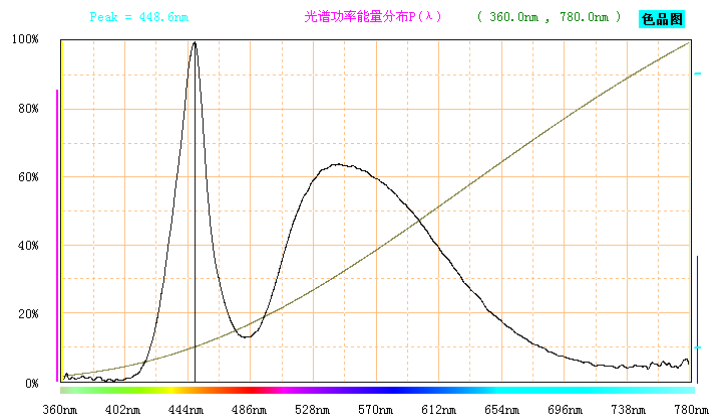

Spectral Power Energy Profile

LED Product Specifications

Part Number: 35836-OP
 Name: Φ8 Straw Hat 0.75W White
 VER: Page 3 of 3

5. Product shipment BIN table

