

36043-SW

MINIATURE 10 AMP DOUBLE-POLE / SIMULTANEOUS SNAP ACTION SWITCH

This rugged Double Pole, Single Throw-Normally Closed double-break Butterfly® mechanism switch. This unique design is ideal for your toughest applications where reliability is a must.

Series 22



APPLICATIONS

- Pressure control sensors
- Pendant controls
- Door openers for transit equipment
- Valve actuator
- Limit Sensor
- Interlocks

End Solder Terminals

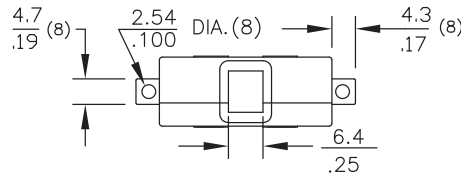

Switch Mechanical / Electrical Characteristics

Pretravel:

0.060 inches max

Overtravel:

0.015 inches min

Operating Force:

17 ± 5 oz

Release Force:

4 oz min

Movement Differential:

0.030 inches ± .009

Operating Point:

0.505 inches ± .011

(from mounting hole centers)

72-1160 Roller

Mechanical Characteristics

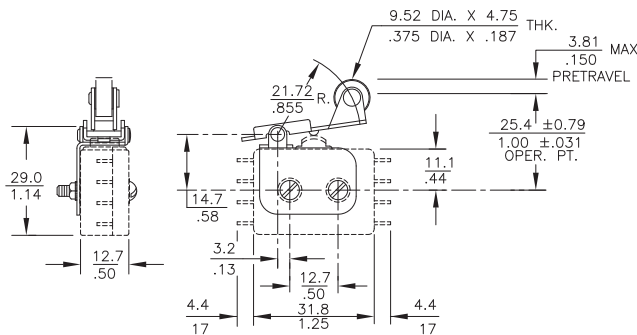

Part Number	Oper. Force	Release Force	Pretravel	Overtravel	Movement Diff.	Operating Point
72-1160 Roller Lever (1)	10 oz max	1.5 oz min	.150 max	.035 min	.070 ± .015	1.0 ± .031

(1) When used with 22-104 basic switch or 22-204 basic switch. (2) When used with 22-304 basic switch

Circuit:

DPDT-DB (Form ZZ)

Electrical Ratings:

Circuitry	125/250 VAC	28 VDC
DPST-DB NO or NC (Form XX or YY)	10 amp (75-80% PF) 1/2 HP 125 VAC	10 amp Ind 15 amp Res
DPDT-DB (Form ZZ)	3/4 HP 250 VAC	7 amp Ind 10 amp Res

ORDERING INFORMATION:

Switches

Part Number	Terminals
22-101	DPST-NO End Solder

STANDARDS / AGENCY / RATINGS:

