



IEC Connector EN60320 C14

0711 Series

Power Rating : 10A 250V AC European
15A 250V AC UL & CSA

Insulation Resistance : over 100M Ω 500V DC

Electric Strength : 2,000V AC for One Minute

Operating Temperature : -25°C to +70°C

Main Unit Material : Thermoplastic UL Flammability
94V-0 & Copper Alloy

Unique Features : Ensure Free of

- Discontinuity
- Short Circuit on Rear Plane
- Hi-Pot Breaking
- Arcing



Power Inlet

Unit : mm

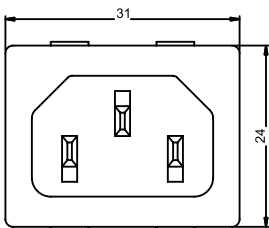

THICKNESS:
0.8~1.2t (X=20.3)
1.3~2.0t (X=20.5)

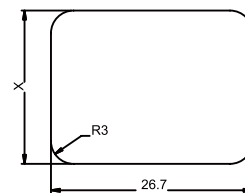

PANEL CUT-OUT

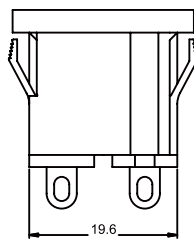
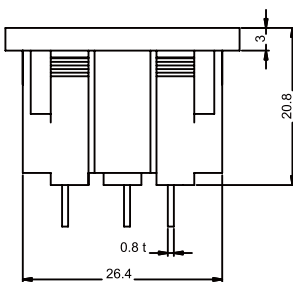

MODEL NO.	TERMINAL OPTION
0711-PN	4.0 mm/SOLDER TAB
0711-PQ	4.8 mm Q.D./SOLDER TAB
0711-PS	2.5 mm/SOLDER TAB
0711-PW1	6.3 mm/Q.D. TAB